

Replace the Clamping Pin on an Everest™ Printer

Use this procedure to replace the clamping pin on an **Everest Printer**.

Rimage approved parts must be used for this process. The product warranty may become void if parts not approved by Rimage are used; equipment or parts are tampered with, misused, neglected, or modified in any respect without the written consent of Rimage.

• **Notes:**

- Your system may not look exactly like the system pictured.
- The terms “Everest” and “printer” are used throughout this document to refer to the Everest II, III, and 600.

< **Caution!** Some cables in this system are latched. Equipment damage may occur if cables are not disconnected appropriately.

Before you begin

1. Stop or pause all jobs.
2. If the printer is attached to an autoloader, power off the **autoloader**.
3. Disconnect the **power cord** from the power outlet.

@ Required tools:

- Phillips #2 screwdriver
- Small flathead screwdriver
- Needle-nose pliers

Remove the Clamping Pin

1. Disconnect all **cables** from the printer.
 - **Printer cable (if on an autoloader)**
 - **USB cable**
 - **Power cord**
2. If the printer is on an autoloader, remove it from the autoloader.
 - < **Caution!** Lift the printer with care. It is very heavy.

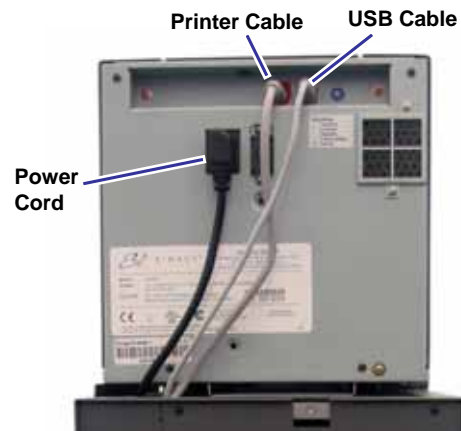

3. Manually slide the **printer tray** all the way out of the printer.
 - a. Open the **printer tray door**.
 - & **Tip:** Use a small flathead screwdriver to open the door.
 - b. Grasp the front of the **printer tray** with a needle-nose pliers and firmly pull out the tray.

Printer Tray Door



4. Remove the **Phillips screws** (Qty. 2) at the back of the print pad.

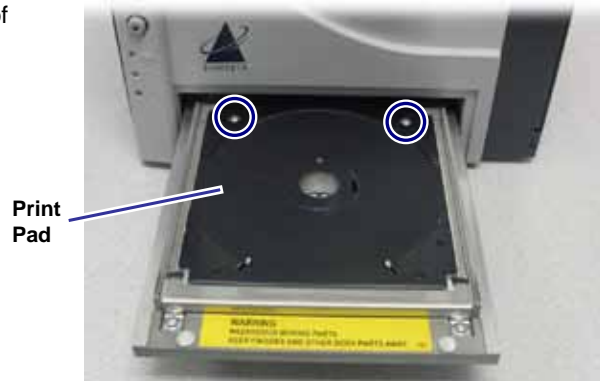

5. Remove the **print pad**.
 - a. Insert your index finger into the hole and grasp the edge of the **print pad**.
 - b. Lift the **print pad** off the printer tray.

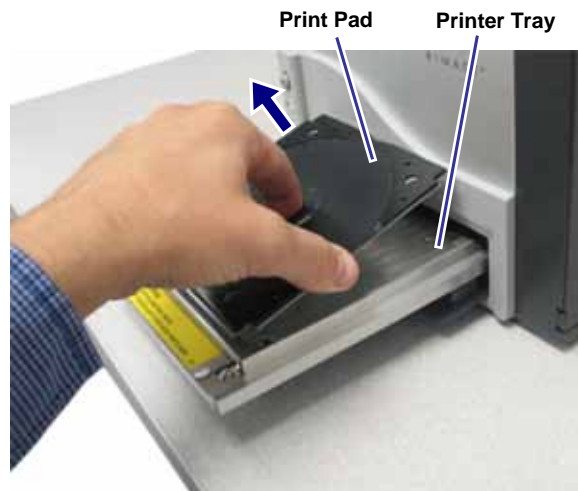

6. Remove the **clamping pins** (Qty. 2).
 - a. Firmly grasp the first **clamping pin** with the needle-nose pliers.
 - b. Pull the **clamping pin** straight up and out of the hole.
 - c. Repeat **steps a and b** for the second clamping pin.



Install the Clamping Pins

1. Insert the replacement **clamping pins** (Qty. 2).
 - a. Align the first **clamping pin** so that the prong faces the hub at the center of the printer tray as shown.

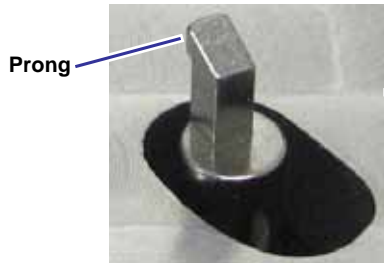

- b. Use the needle-nose pliers to press the **clamping pin** firmly down into the hole.
 - c. Repeat steps a and b for the second clamping pin.
2. Install the **print pad**.
 - a. Position the **print pad** on the printer tray.

J Important! Make sure the front edge of the print pad fits under the metal lip of the printer tray.

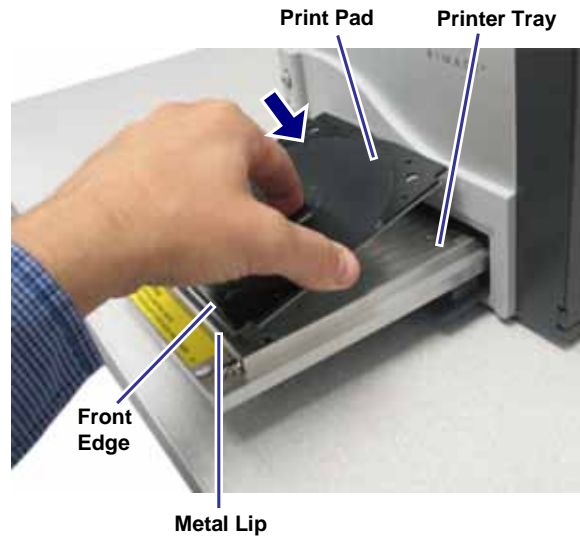

- b. Install the **Phillips #2 screws** (Qty. 2) at the back of the print pad.
 - c. Manually push the **printer tray** back into the printer.

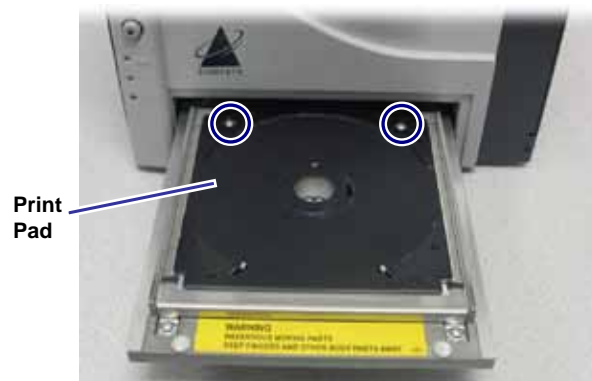

3. If necessary, place the **printer** on the autoloader.

< **Caution!** Lift the printer with care. It is very heavy.

4. Connect the **cables** to the rear of the printer.

- **USB cable**
- **Printer cable (if on an autoloader)**
- **Power cord**

The printer is ready for use.

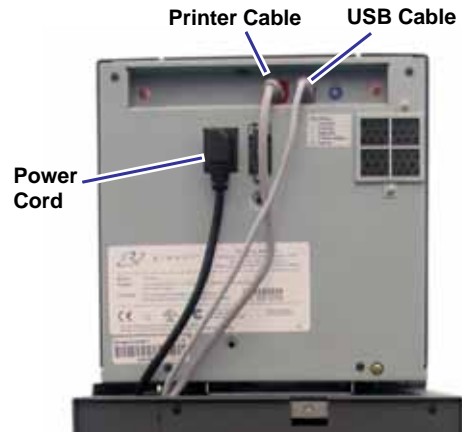

Support information

Europe

Contact Rimage Services Europe:

www.rimage.de

Email: support@rimage.de

Tel: +49-(0) 6074-8521-0

US, Asia/Pacific, Mexico/Latin America

Contact Rimage Services:

www.rimage.com/support

KnowledgeBase: <http://rimage.custhelp.com>

Login and select the **Ask a Question** tab.

Tel: North America: 800-553-8312

Asia/Pacific, Mexico/ Latin America: 952-946-0004

When you contact Rimage Services, please provide:

- Unit serial number and software version.
- Functional and technical description of the problem.
- Exact error message received.

Rimage Corporation reserves the right to make improvements to the equipment and software described in this document at any time without any prior notice. Rimage Corporation reserves the right to revise this publication and to make changes from time to time in the content hereof without obligation of Rimage Corporation to notify any person or organization of such revisions or changes.