



Rimage Autostar II™ and Protégé II™ Setup and Installation

Before you begin:

This document includes instructions for setting up the Autostar II and the Protégé II. These products are part of the Producer II family of products.

The term 'Producer II' is used throughout this document to refer to the Autostar II or Protégé II.

1 Setup the PC.

Each Autostar II and Protégé II comes with a Rimage control center PC.

Before you setup your Producer II, unpack and set up the control center PC included with your system.

The Rimage software and printer driver are already installed on the control center PC.

2 Prepare the Producer II.

- a. On the Producer II, open the **front door**.
- b. Cut the plastic **tie wrap** from the lift arm.

 **Caution!** Do not cut the belt or cable!

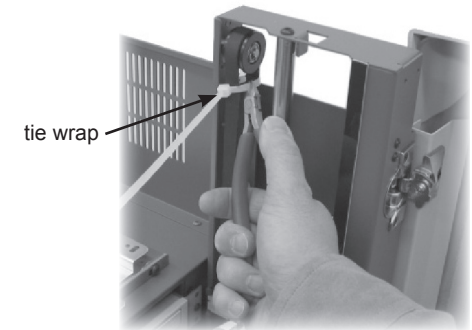

- c. Remove the **tape** from the mailbox feed tray.

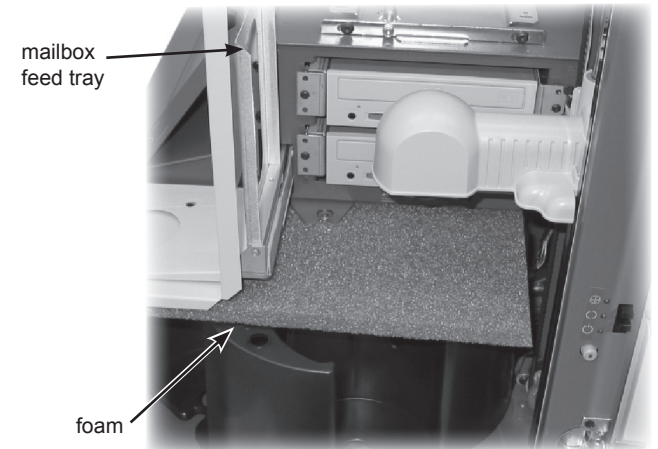

- d. Remove the **shipping foam** inserted above the carousel.
- e. Close the **front door**.

3 Set up your printer (Everest).

- a. Unpack the Everest printer. Refer to the *Everest Unpacking and Setup Instructions* included with your Everest printer.

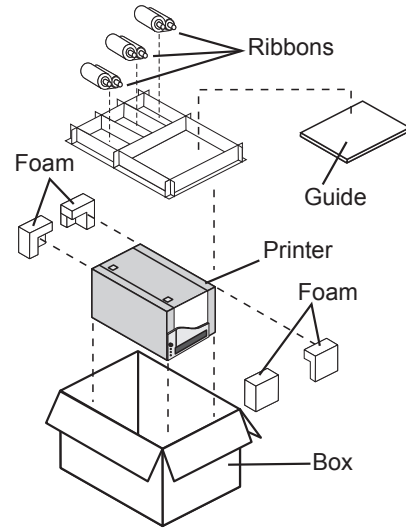

- b. Open the Producer II side cover.

- c. Place the printer on the Producer II so that the plastic feet slide into the slots on the printer plate.

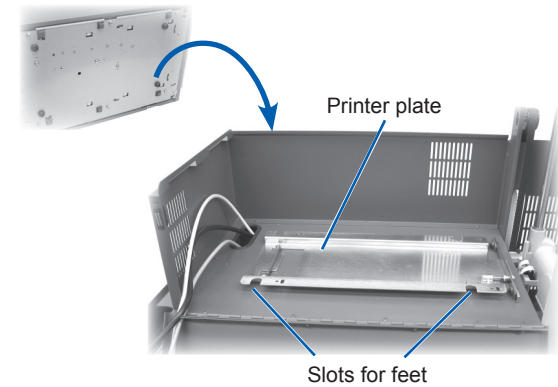

OR

3 Set up your printer (Prism).

- a. Open the Prism printer packing box.
- b. Remove the **packing foam** from the ends of the Prism printer.
- c. Remove the **plastic bag** from the Prism printer.
- d. Remove the **top cover** of the Prism printer.
- e. Remove the **foam inserts**.
- f. Replace the **top cover**.

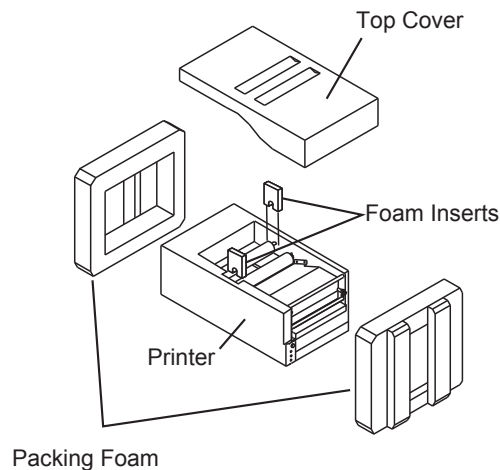

- g. Open the Producer II side cover.

- h. Place the printer on the Producer II so that the plastic feet slide into the slots on the printer plate.

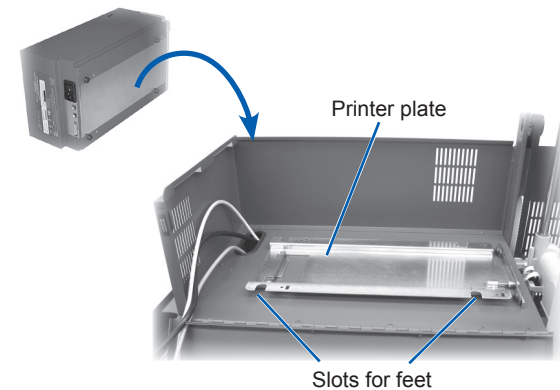

4 Connect the printer cables (Everest).

a. Connect the **printer cable** from the Producer II to the printer.

c. Connect the **USB cable** from the Producer II to the printer.

b. Connect the **power cord** from the Producer II to the printer.

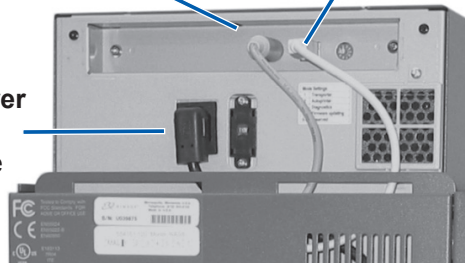

d. Close the Producer II **side cover**.

OR

4 Connect the printer cables (Prism).

a. Lift the Prism printer up from the printer plate and turn the rear as shown below. This will allow access to the cable connections.

b. Connect the **USB cable** from the Producer II to the printer.

d. Connect the **power cord** from the Producer II to the printer.

c. Connect the **printer cable** from the Producer II to the printer.

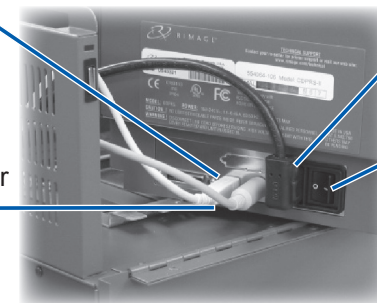

e. Press the Prism printer **power switch**.

f. Slide the **Prism printer** back into place.

g. Close the Producer II **side cover**.

5 Connect the Producer II cables.

a. Connect the **USB cable** from the Producer II to the PC.

b. Connect the **serial cable** from the Producer II to the PC.

c. Connect the **power cord** from the Producer II to the power outlet.

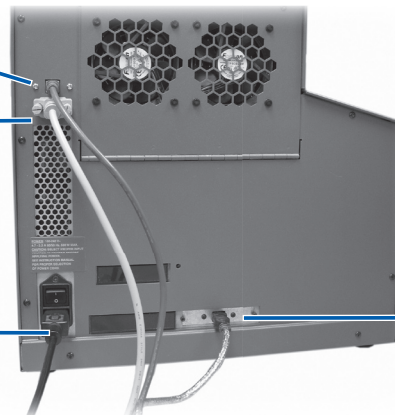

d. Connect the **FireWire cable** from the Producer II to the PC.

6 Power on the Producer II.

To power on the Producer II, press the **power switch**.

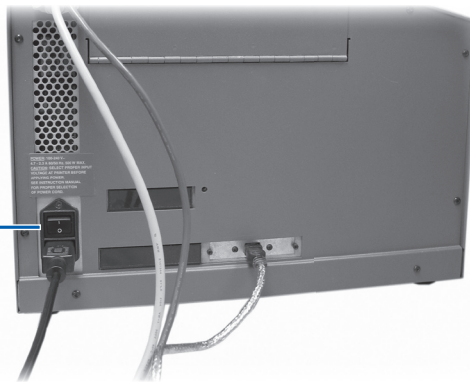

7 Activate your Rimage Software.

You have 30 days to activate your Rimage software. Until your software is activated, you will be prompted to activate your software each time you use the Rimage software.

When the activation dialog displays, select an option and follow the onscreen prompts to activate your software.

8 Learn more.

For information about submitting orders to the Producer II across a network, refer to the *Advanced Setup Guide* included on your software disc. The *Advanced Setup Guide* is also located on the control center PC at Start > Programs > Rimage > Manuals.

For information about operating and maintaining the Autostar II or Protégé II, refer to the *Autostar II and Protégé II User Guide* included with your product.

For additional support and product information, go to www.rimage.com/support.html.